

## Dot-On XS



### Functional Specifications

RF air protocol	EPC Class 1 Gen 2; ISO18000-6C
Operating frequency	UHF 902-928 MHz (US); 866-868 MHz (EU)
IC type	Alien Higgs-3
Memory configuration	96-EPC bits; 512-bit user memory
Functionality	Read / write (user programmed)
Memory – expected read / write cycles	100,000 cycles at 77°F (25°C)
Data retention	10 years
Read rate	400 tags per second for 96-EPC bit number
Warranty (limited)	1 year

### Performance Characteristics

Read range on metal, 4W EIRP (2W ERP)*	Up to 5 ft (1.5 m)
Polarization	Linear
Performance quality	100% tested

\*Actual read range may vary based upon specific application case and antenna power

### Physical Specifications

Material	Ceramic
Mounting system	Epoxy
Color	Black

### Environmental and Industry Compliance

FDA	Designed to comply with FDA guidelines
RoHS	EU Directive 2002/95/EC

**Radiation Pattern**

On metal

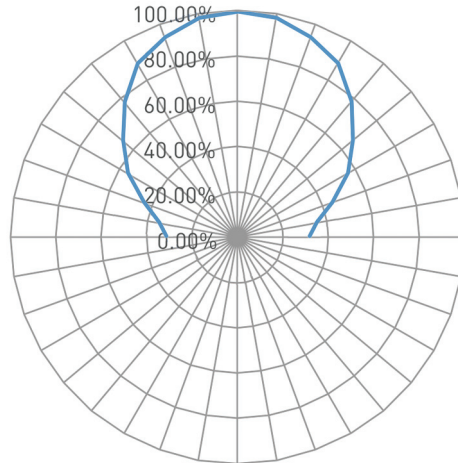

**Operational and Environmental Specifications**

Operational temperature	
Cold	-40°F (-40°C)
Dry heat	+185°F (+85°C)
Application temperature	
Cold	-40°F (-40°C)
Dry heat	+302°F (+150°C)
Humidity	
Operational humidity	5%-95% non-condensing
Storage humidity	5%-95% non-condensing
Shock (drop)	3 ft (1 m) to concrete/granite up to 200 cycles
IP classification	IP68

**Product Dimensions and Weight**

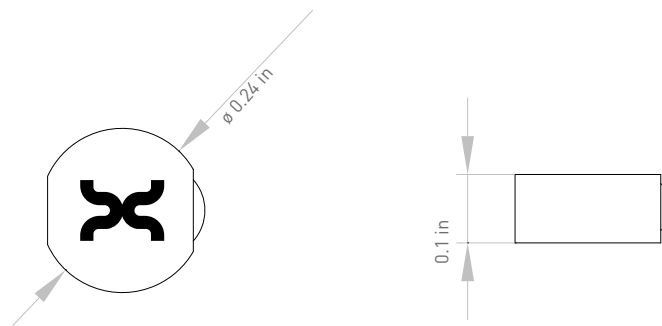

Dimensions	ø 0.24 x 0.1 in (ø 6 x 2.5 mm)
Weight	0.02 oz (0.5 g)

## Dot-iN XS



### Functional Specifications

RF air protocol	EPC Class 1 Gen 2; ISO18000-6C
Operating frequency	UHF 902-928 MHz (US); 866-868 MHz (EU)
IC type	Alien Higgs-3
Memory configuration	96-EPC bits; 512-bit user memory
Functionality	Read / write (user programmed)
Memory – expected read / write cycles	100,000 cycles at 77°F (25°C)
Data retention	10 years
Read rate	400 tags per second for 96-EPC bit number
Warranty (limited)	1 year

### Performance Characteristics

Read range embedded in metal, 4W EIRP (2W ERP)*	Up to 3 ft (1 m)
Polarization	Linear
Performance quality	100% tested

\*Actual read range may vary based upon specific application case and antenna power

### Physical Specifications

Material	Ceramic
Mounting system	Epoxy
Color	White

### Environmental and Industry Compliance

FDA	Designed to comply with FDA guidelines
RoHS	EU Directive 2002/95/EC

**Radiation Pattern**

In metal

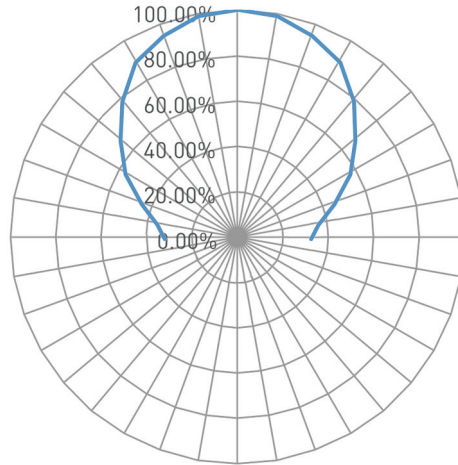

**Operational and Environmental Specifications**

Operational temperature	
Cold	-40°F (-40°C)
Dry heat	+185°F (+85°C)
Application temperature	
Cold	-40°F (-40°C)
Dry heat	+302°F (+150°C)
Humidity	
Operational humidity	5%-95% non-condensing
Storage humidity	5%-95% non-condensing
Shock (drop)	3 ft (1 m) to concrete/granite up to 200 cycles
IP classification	IP68

**Product Dimensions and Weight**

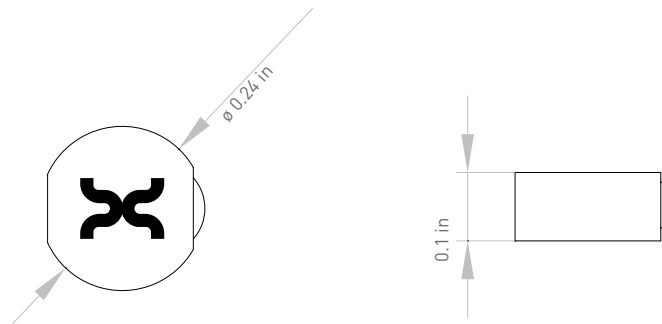

Dimensions	ø 0.24 x 0.1 in (ø 6 x 2.5 mm)
Weight	0.02 oz (0.5 g)